

M7205
M7215

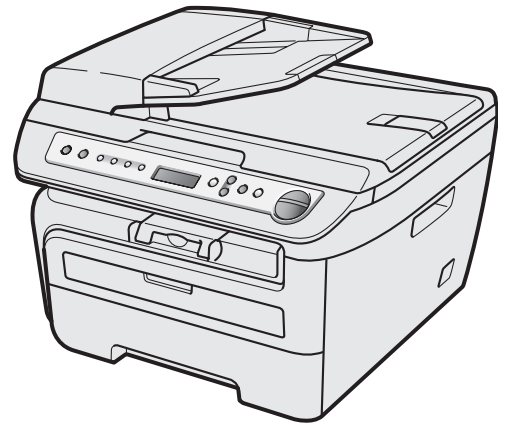

Before you can use the machine, you must set up the hardware and install the driver. Please read this 'Quick Setup Guide' for proper set up and installation instructions.

STEP 1

Setting Up the Machine







STEP 2

Installing the Driver & Software

Setup is Complete!

Keep this 'Quick Setup Guide' and the supplied CD-ROM in a convenient place for quick and easy reference at all times.

Symbols used in this guide

 Warning	 Caution	 Improper Setup
Warnings tell you what to do to prevent possible personal injury.	Cautions specify procedures you must follow or avoid to prevent possible damage to the machine or other objects.	Improper Setup icons alert you to devices and operations that are not compatible with the machine.
 Note	 User's Guide, Software User's Guide or Network User's Guide	
Notes tell you how you should respond to a situation that may arise or give tips about how the current operation works with other features.	Indicates reference to the User's Guide or Software User's Guide or Network User's Guide which is on the CD-ROM we have supplied.	

Safety Precautions

To use the machine safely	2
Regulations	3
IEC60825-1+A2:2001 Specification	3
Disconnect device	3
Radio interference	3

Getting Started

Carton components	4
Control panel	5

STEP 1—Setting Up the Machine

Installing the drum unit and toner cartridge assembly	6
Loading paper in the paper tray	7
Install the power cord	8
Selecting your language	8
Setting the LCD contrast	9

STEP 2—Installing the Driver & Software

Supplied CD-ROM 'Multi-Function Suite'	10
--	----

Windows®

For USB Interface Cable Users (For Windows® 2000 Professional/XP/XP Professional x64 Edition/Windows Vista®)	12
---	----

Macintosh®

For USB Interface Cable Users	14
For Mac OS® X 10.2.4 or greater	14

Consumables and Options

Consumables	16
-------------------	----

To use the machine safely

Please keep these instructions for later reference and read them before attempting any maintenance.

Warning



Before cleaning the inside of the machine, unplug the power cord from the electrical socket.

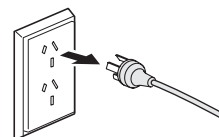

DO NOT handle the plug with wet hands. Doing this might cause an electrical shock.

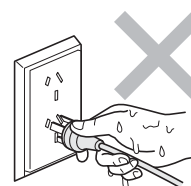

Always make sure the plug is fully inserted.



After you have just used the machine, some internal parts of the machine will be extremely hot. When you open the front or back cover of the machine, DO NOT touch the shaded parts shown in the illustrations.

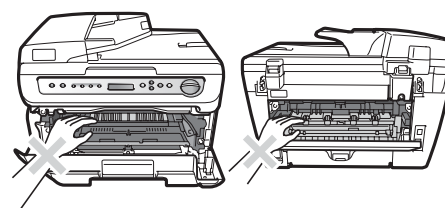

To prevent injuries, be careful not to put your hands on the edge of the machine under the document cover or scanner cover as shown in the illustrations.

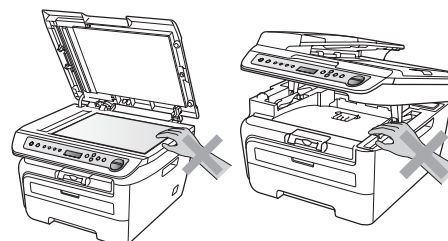

(M7215 only) To prevent injuries, DO NOT put your fingers in the areas shown in the illustrations.

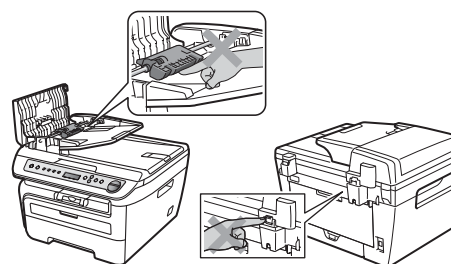

DO NOT use a vacuum cleaner to clean up scattered toner. Doing this might cause the toner dust to ignite inside the vacuum cleaner, potentially starting a fire. Please carefully clean the toner dust with a dry, lint-free cloth and dispose of it according to local regulations.



If moving your machine, use the handholds provided. First making sure to disconnect any cables.



DO NOT use any flammable substances, spray or organic solvent/liquids containing alcohol/ammonia to clean the inside or outside of the machine. Doing this may cause a fire or electrical shock. Refer to *Routine maintenance* on page 55 for how to clean the machine.



Plastic bags are used in the packaging of your machine. To avoid the danger of suffocation, keep these bags away from babies and children.

Note

The fuser unit is marked with a Caution label. DO NOT remove or damage the label.

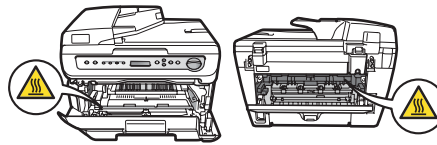

Regulations

IEC60825-1+A2:2001 Specification

This machine is a Class 1 laser product as defined in IEC60825-1+A2:2001 specifications. The label shown below is attached in countries where required.

This machine has a Class 3B Laser Diode which emits invisible laser radiation in the Scanner Unit. The Scanner Unit should not be opened under any circumstances.



Internal laser radiation

Wave length: 780 - 800 nm

Output: 10 mW max.

Laser Class: Class 3B



Warning

Use of controls, adjustments or performance of procedures other than those specified in this manual may result in hazardous radiation exposure.

Disconnect device

This product must be installed near an AC power outlet/electrical socket that is easily accessible. In case of emergencies, you must disconnect the power cord from the AC power outlet/electrical socket to shut off power completely.

Radio interference

This product complies with EN55022 (CISPR Publication 22)/Class B. When connecting the machine to a computer, ensure that you use the following interface cables.

A USB cable which must not exceed 2.0 metres in length.

Carton components



Carton components may vary from one country to another.
Save all packing materials and the carton in case for any reason you must ship your machine.

Warning

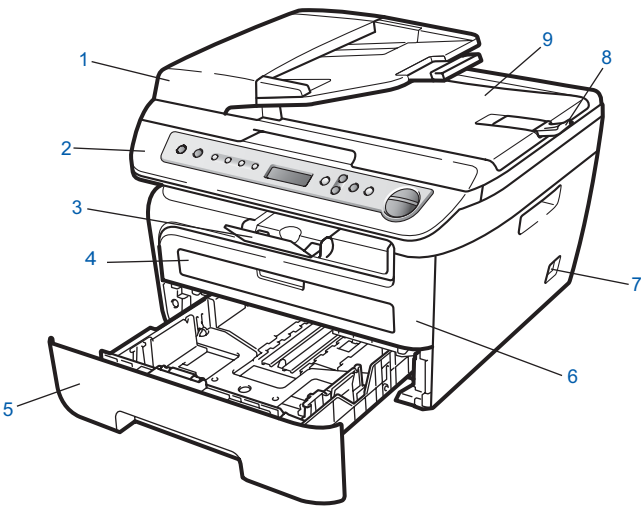
Plastic bags are used in the packaging of your machine. To avoid danger of suffocation, please keep these bags away from babies and children.

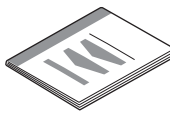
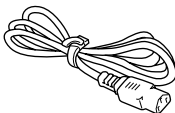

- | | |
|--|---|
| 1 Automatic Document Feeder (ADF) (M7215 only) | 6 Front Cover |
| 2 Control Panel | 7 Power Switch |
| 3 Face-down Output Tray Support | 8 ADF Document Output Support Flap (M7215 only) |
| 4 Manual Feed Slot | 9 Document Cover |
| 5 Paper Tray | |

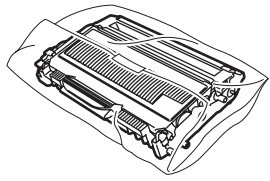
 CD-ROM	 Quick Setup Guide	 AC Power Cord
 USB Interface Cable	 Drum Unit Assembly (including Toner Cartridge)	

- Do NOT connect the interface cable at this time. Connecting the interface cable is done during the software installation process.
To ensure safe operation the supplied plug must be inserted only into a standard power outlet that is properly grounded through the standard electrical wiring. Non grounded equipment may cause an electrical shock hazard, and may cause excessive electrical noise radiation.
- USB interface cable
Please make sure you use a USB 2.0 interface cable that is no longer than 6 feet (2 metres). When you use a USB cable, make sure you connect it to the USB port of your computer and not to a USB port on a keyboard or non-powered USB hub.

Control panel

M7205 and M7215 have the same keys.

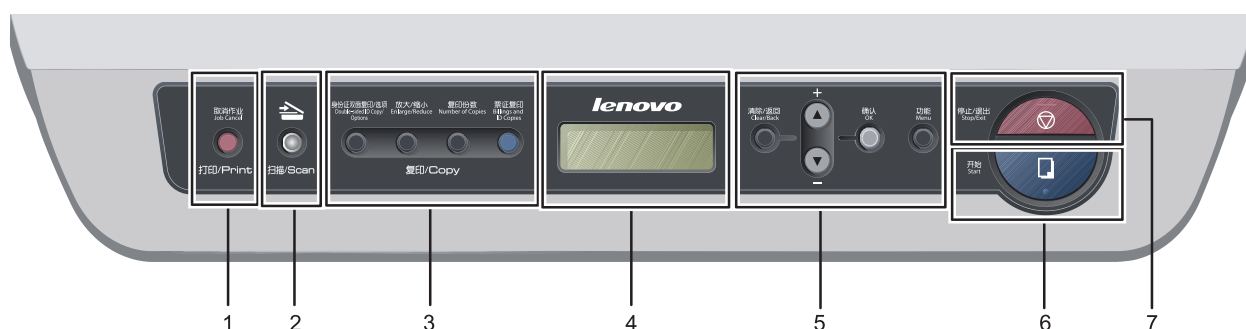

- | | |
|--------------------------------|-----------------|
| 1 Job Cancel | 5 Menu keys |
| 2 Scan key | 6 Start key |
| 3 Copy keys | 7 Stop/Exit key |
| 4 LCD (Liquid Crystal Display) | |

 For the details of the control panel, see *Control panel overview* in *Chapter 1* of the *User's Guide*.

Note

When you move the machine, grasp the side handholds that are under the scanner. Do NOT carry the machine by holding it at the bottom.

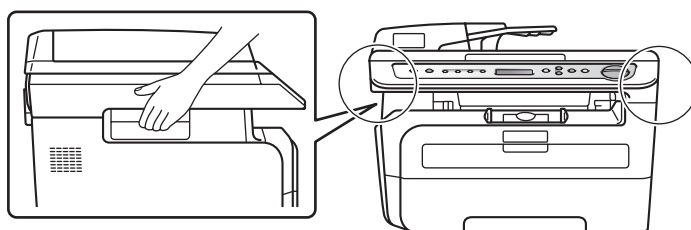

■ Illustration in this Quick Setup Guide are based on M7215.

1 Installing the drum unit and toner cartridge assembly

⊘ Improper Setup

DO NOT connect the interface cable.
Connecting the interface cable is done when installing the driver.



1 Open the front cover.

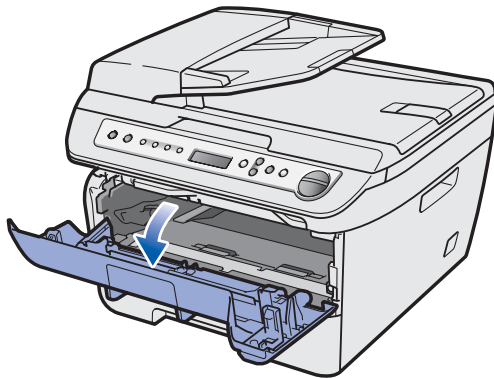

2 Unpack the drum unit and toner cartridge assembly.

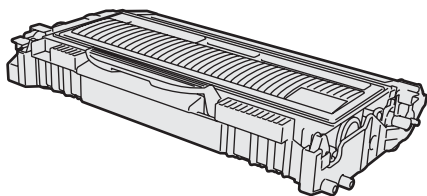

3 Gently shake it from side to side several times to distribute the toner evenly inside the assembly.

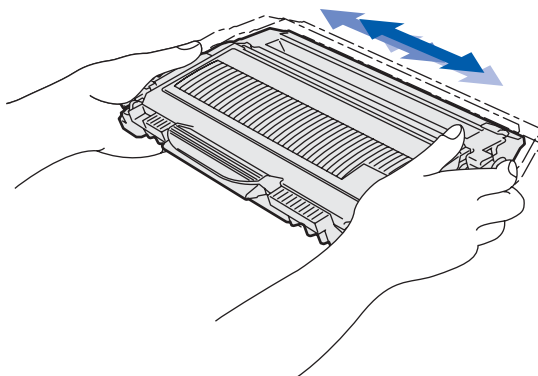

4 Put the drum unit and toner cartridge assembly into the machine.

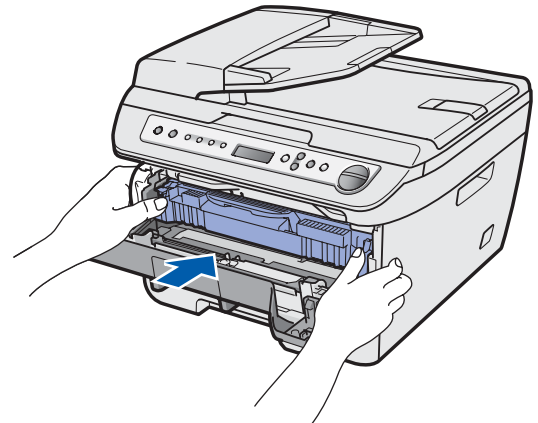
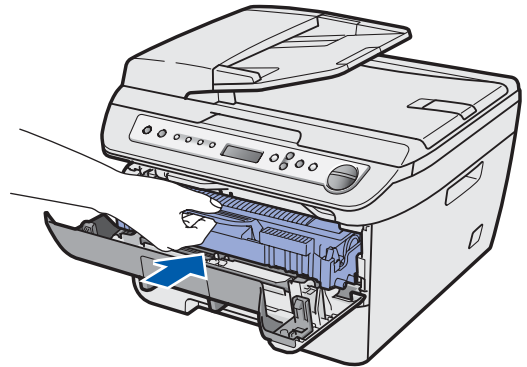

5 Close the front cover of the machine.

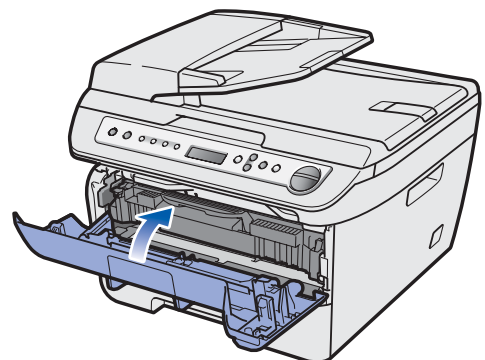

2 Loading paper in the paper tray

- 1** Pull the paper tray completely out of the machine.

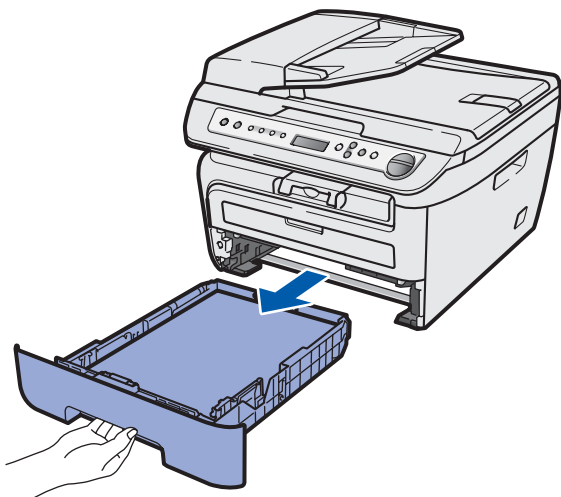

- 2** While pressing the green paper-guide release lever, slide the paper guides to fit the paper size you are using. Make sure that the guides are firmly in the slots.

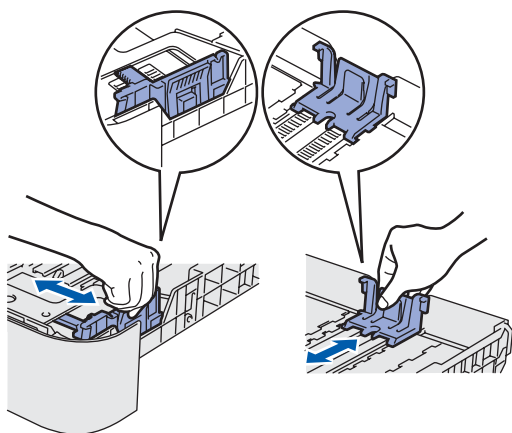

- 3** Fan the stack of paper well to avoid paper jams and misfeeds.

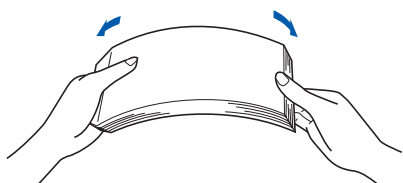

- 4** Put paper in the paper tray. Make sure that the paper is flat in the tray and below the maximum paper mark (1).

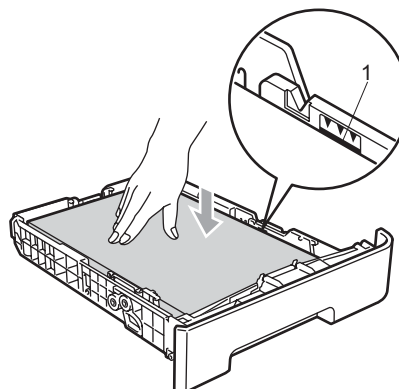

! Caution

Make sure the paper guides touch the sides of the paper so it will feed properly. If you do not this, it may cause damage to your machine.

- 5** Put the paper tray firmly back into the machine. Make sure that it is completely inserted into the machine.

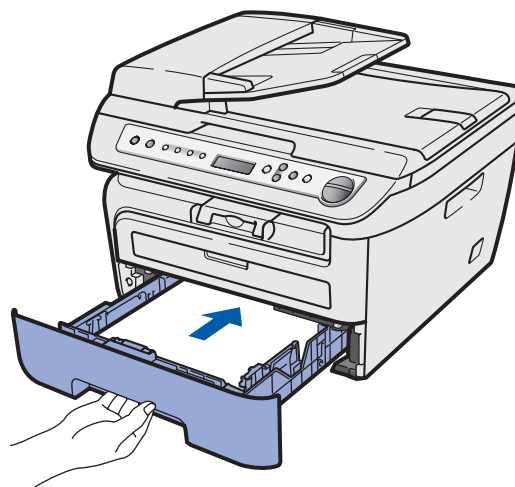

3 Install the power cord

- 1** Make sure that the machine's power switch is off. Connect the AC power cord to the machine.

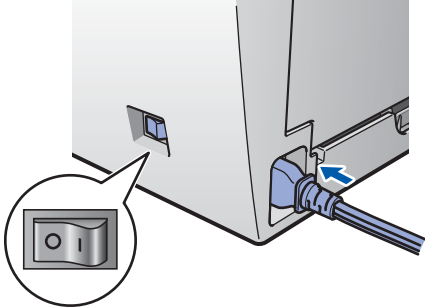







- 2** Plug the AC power cord into an AC outlet. Turn the power switch on.

**4 Selecting your language**

- 1** Press **Menu**.
- 2** Press or to select
1. 常规设置 (1.General Setup). Press **OK**.
- 3** Press or to select
0. 语言 (0.Local Language). Press **OK**.
- 4** Select your language by using or and then press **OK**.
- 5** Press **Stop/Exit**.

5 Setting the LCD contrast

You can change the contrast to help the LCD look lighter or darker.

- 1** Press **Menu** and  or  to select 1.General Setup. Press **OK**.
- 2** Press  or  to select 5.LCD Contrast. Press **OK**.
- 3** Press  to increase the contrast.
—OR—
Press  to decrease the contrast.
Press **OK**.

Supplied CD-ROM 'Multi-Function Suite'

Windows®



Install Software

You can install the printer, scanner, PC-FAX Send/Receive drivers and the various utility items.



Documentation

View the Software User's Guide and User's Guide in PDF format. The Software User's Guide includes instructions for features available when connected to a computer. (eg. printing and scanning details)



Customer Support

You can visit our website at <http://www.lenovo.com>.



Note

Multi-Function Suite includes the Printer Driver, Scanner Driver, ControlCenter3.

Macintosh®

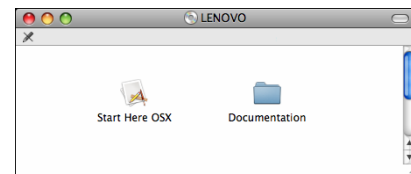

Start Here OSX

You can install the printer driver for Mac OS® X 10.2.4 or greater.



Documentation

View the Software User's Guide and User's Guide in PDF format. The Software User's Guide includes instructions for features available when connected to a computer. (eg. printing and scanning details)

Installing the Driver & Software

Follow the instructions on this page for your operating system and interface.

Windows®

For USB Interface Cable Users..... 12



Macintosh®

For USB Interface Cable Users..... 14



The screens for Windows® in this Quick Setup Guide are based on Windows® XP.
The screens for Mac OS® X in this Quick Setup Guide are based on Mac OS® X 10.4.

For USB Interface Cable Users (For Windows® 2000 Professional/XP/XP Professional x64 Edition/Windows Vista®)

Important

Make sure that you have finished the instructions from step 1 *Setting Up the Machine* on pages 6 through 9.

Note

Please close any applications running before installing the Multi-Function Suite.

- 1 Turn off and unplug the machine from the AC outlet and disconnect it from your computer, if you already connected an interface cable.

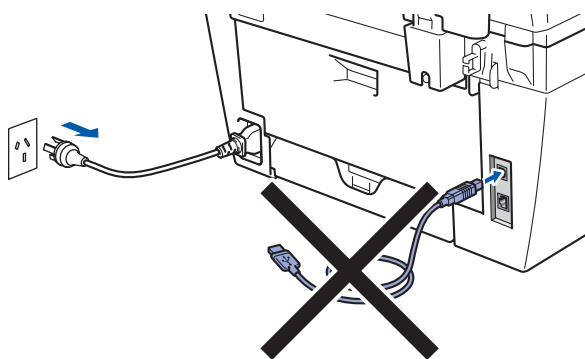

- 2 Turn on your computer. (You must be logged on with administrator rights.)
- 3 Put the supplied CD-ROM for Windows® into your CD-ROM drive. If the model name screen appears, choose your machine. If the language screen appears, choose your language.

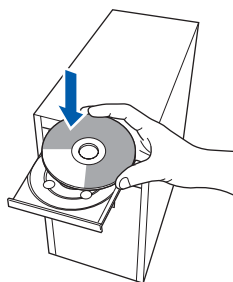

Note

This printer driver supports English and Simplified Chinese OS. If you use other language versions, you will see the warning message below.



Then click "OK" to finish the installation.

- 4 The CD-ROM main menu will appear. Click **Install Software**.



Note

- If this window does not appear, use Windows® Explorer to run the **start.exe** program from the root folder of the CD-ROM.
- For Windows Vista®, when the User Account Control screen appears, click **Allow**.

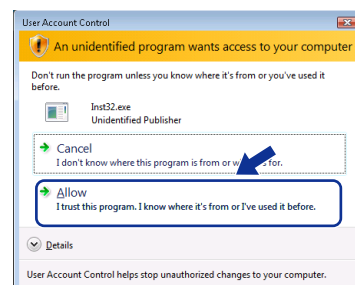

5 B-Click Multi-Function Suite Install.

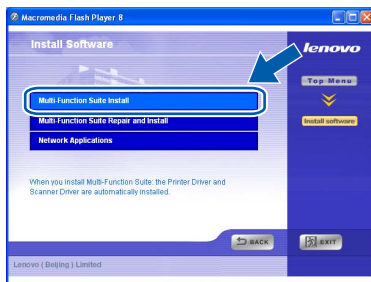

6 When the Software License Agreement window appears, click **Yes** if you agree to the Software License Agreement.

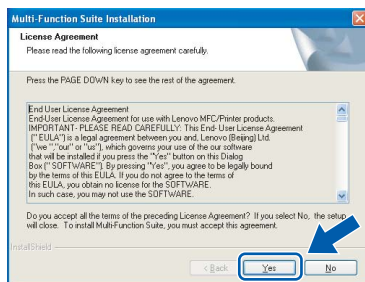

7 Choose **Standard** and then click **Next**. The installation will continue.

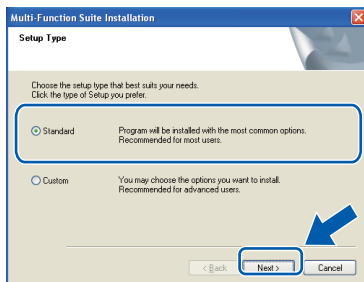

8 When this screen appears, connect the USB interface cable to your PC, and then connect it to the machine.

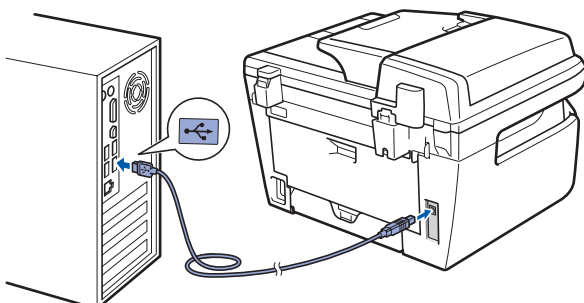
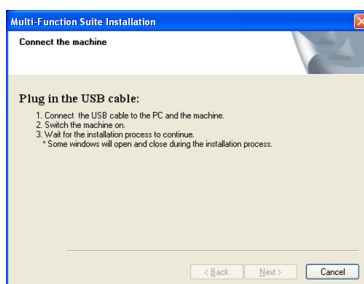

Improper Setup

DO NOT connect the machine to a USB port on a keyboard or a non-powered USB hub. Lenovo recommends that you connect the machine directly to your computer.

9 Plug the AC power cord into an AC outlet. Turn the power switch on.



The installation of drivers will automatically start. **The installation screens appear one after another, please wait for a while.**

Improper Setup

DO NOT try to cancel any of the screens during this installation.

10 When the On-Line Registration screen is displayed, make your selection and follow the on-screen instructions.

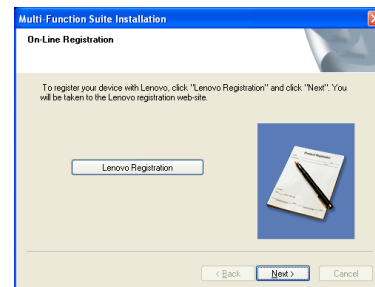

11 Click **Finish** to restart your computer. (After restarting the computer, you must be logged on with Administrator rights.)

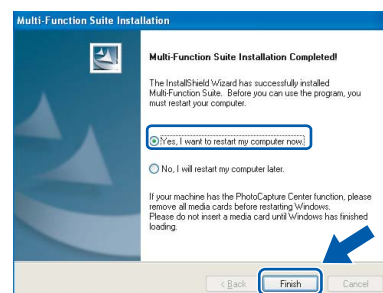

The Multi-Function Suite (including printer driver and scanner driver) has been installed and the installation is now complete.

For USB Interface Cable Users

For Mac OS® X 10.2.4 or greater

Important

Make sure that you have finished the instructions from step 1 *Setting Up the Machine* on pages 6 through 9.

Note

For Mac OS® X 10.2.0 to 10.2.3 users, upgrade to Mac OS® X 10.2.4 or greater.

- 1 Plug the AC power cord into an AC outlet. Turn the power switch on.

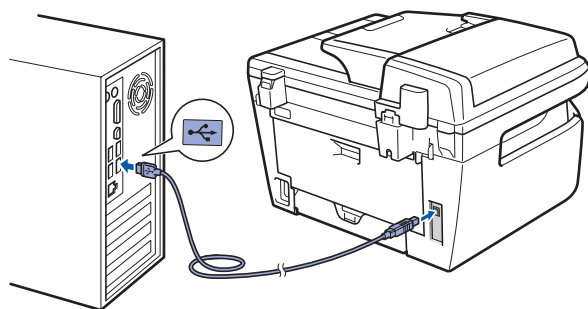

- 2 Connect the USB interface cable to your computer, and then connect it to the machine.

**Improper Setup**

DO NOT connect the machine to a USB port on a keyboard or a non-powered USB hub. Lenovo recommends that you connect the machine directly to your computer.

- 3 Turn on your Macintosh®.
- 4 Put the supplied CD-ROM into your CD-ROM drive.

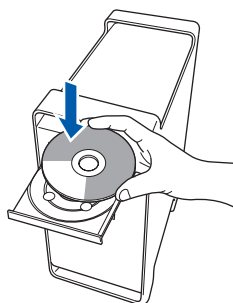

- 5 Double-click the **Start Here OSX** icon to install.

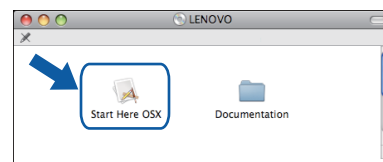

- 6 Follow the on-screen instructions. Then, restart your Macintosh®.

For Mac OS® X 10.2.4 to 10.2.8 users:
Go to step 9.

For Mac OS® X 10.3 or greater users:
Go to step 7.

- 7 The Lenovo software will search for the Lenovo device. During this time the following screen will appear.

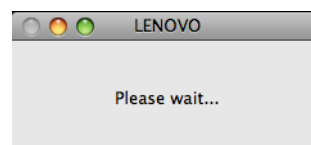

- 8 When this screen appears, click **OK**.

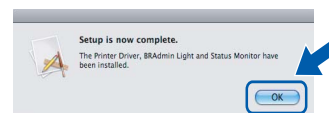

- 9 For Mac OS® X 10.3.x or greater users:
The driver have been installed and the installation is now complete.

- 9 For Mac OS® X 10.2.4 to 10.2.8 users:
Click **Add**.

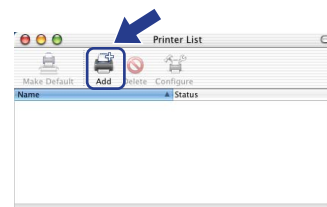

10 Choose **USB**.

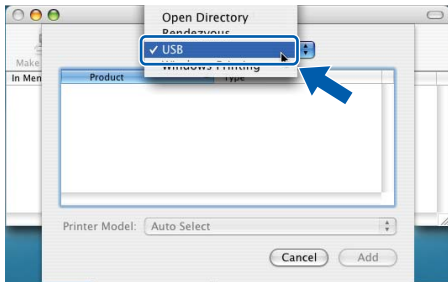

11 Choose your model name, and then click **Add**.

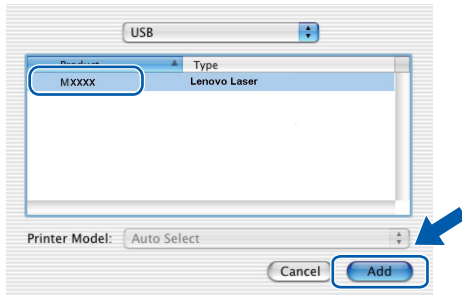

12 Click **Print Center**, then **Quit Print Center**.

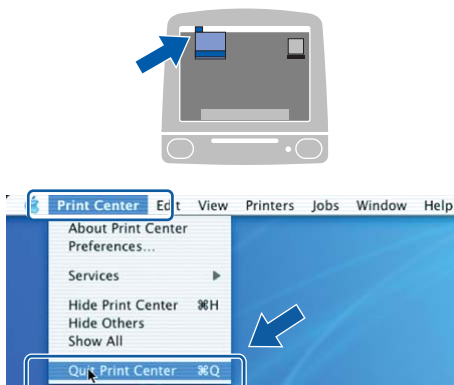

The driver have been installed.

Consumables

When the time comes to replace consumable items, an error message will be indicated on the LCD. For more information about the consumables for your machine, visit us at <http://www.lenovo.com> or contact your local Lenovo reseller.

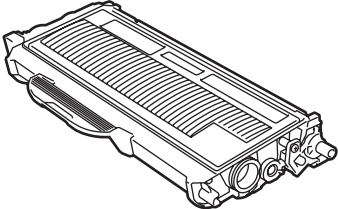
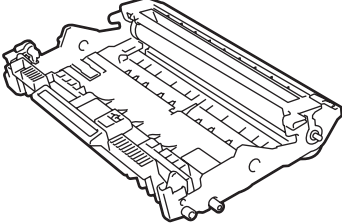
Toner Cartridge	Drum Unit
LT2922/LT2922H	LD2922
	

Trademarks

Lenovo, Lenovo 联想, 联想, and other Lenovo markings or identification are either trademarks or registered trademarks in Chinese Mainland and/or other countries/territories of Lenovo (Beijing) Limited or its affiliates.

Windows Vista is either a registered trademark or a trademark of Microsoft Corporation in the United States and other countries.

Microsoft, Windows and Windows Server are registered trademarks of Microsoft Corporation in the United States and/or other countries.

Macintosh and TrueType are registered trademarks of Apple Inc.

Each company whose software title is mentioned in this manual has a Software Licence Agreement specific to its proprietary programs.

All other brand and product names mentioned in this manual are trademarks or registered trademarks of their respective companies.

Compilation and Publication

Under the supervision of Lenovo (Beijing) Limited, this manual has been compiled and published, covering the latest product descriptions and specifications.

The contents of this manual and the specifications of this product are subject to change without notice.

Lenovo reserves the right to make changes without notice in the specifications and materials contained herein and shall not be responsible for any damages (including consequential) caused by reliance on the materials presented, including but not limited to typographical and other errors relating to the publication.

This product is designed for use in a Professional Environment.

©2008 Lenovo (Beijing), Limited ©1998-2008 TROY Group, Inc. ©1983-2008 PACIFIC SOFTWARES INC. This product includes the "KASAGO TCP/IP" software developed by ELMIC WESCOM, INC. ©2008 Devicescape Software, Inc. This product includes RSA BSAFE Cryptographic software from RSA Security Inc. Portions Copyright for ICC profiles 2003 by European Color Initiative, www.eci.org. ALL RIGHTS RESERVED

lenovo